

# LGS Water Resistant Slim Lightbox

Installation Instruction



## LGS Water Resistant Slim Lightbox

Installation Instruction

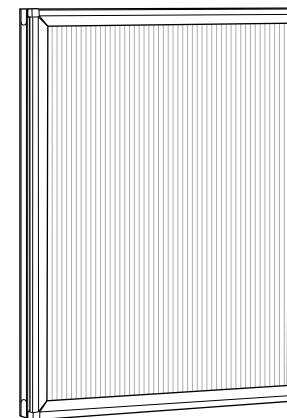

Tel | 04-711-2234  
Fax | 04-711-2469  
E-mail | [service@lightek.com.tw](mailto:service@lightek.com.tw)

No.404, Yanping Rd., Changhua City,  
Changhua 500, Taiwan, R.O.C.

[www.lightek.com.tw](http://www.lightek.com.tw)

Green technology  
creates infinite possibilities

## Graphic Insertion Instructions

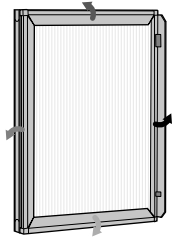

### Step 1

Simply snap open each frame edge.

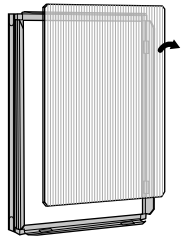

### Step 2

Lift the transparent protective sheet.

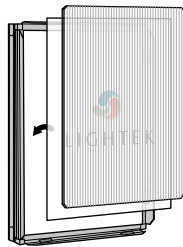

### Step 3

Put the graphic between the transparent sheet and the light box.



### Step 4

Snap the frame edges closed.



## Wall Mounting Instructions

### Parts List

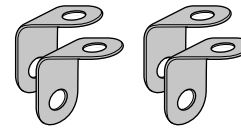

L Bracket \*4

(Depending on the size of light box)

※ **Short Side** Fix to the light box

**Long Side** Mount on the wall

※ Drainage holes are provided at the bottom of light box.

### Invisible Type



### Step 1

Mount L bracket on the wall.

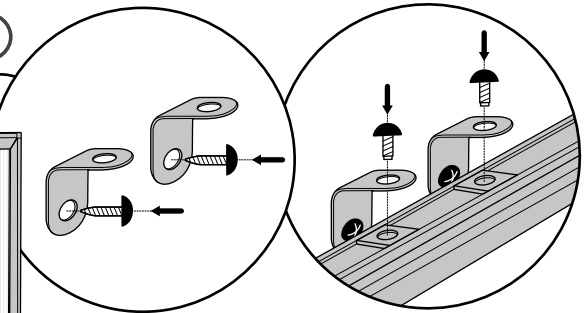

### Step 2

Fix L bracket to the light box with screws by using a screwdriver.

### Visible Type



### Step 1

Fix L bracket to the light box with screws.

### Step 2

Mount L brackets on the wall.

